

Apotop

Selfie Remote Controller

i-Selfie

使用說明



1. 進入iPhone的設定，開啟藍牙



2. 長按 i-Selfie 的按鈕，直到 LED 閃爍之後放開。



3. 「裝置」偵測到「i-Selfie」，點選進行配對。



4. 選擇「Pair」之後，LED 停止閃爍，配對完成，裝置顯示「已連線」。

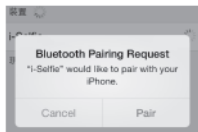

5. 開啟iPhone相機，按下按鈕即可拍照。



NCC警語

第十二條：

經型式認證合格之低功率射頻電機，非經許可，公司、商號或使用者均不得得擅自變更頻率、加大功率或變更通原設計之特性及功能。

第十四條：

低功率射頻電機之使用不得影響飛航安全及干擾合法通信；經發現有干擾現象時，應立即停用，並改善至無干擾時方得繼續使用。前項合法通信，指依電信法規定作業之無線電通信。低功率射頻電機須忍受合法通信或工業、科學及醫療用電波輻射性電機設備之干擾。

Apotop

Selfie Remote Controller

i-Selfie

User's Guide



1. On your iPhone. Go to **Settings** > turn on **Bluetooth**

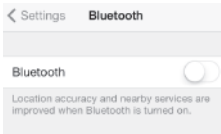

2. Tap and hold the button of **i-Selfie**, until the LED light blinked



3. When iPhone detects **i-Selfie**, tap it to connect two device

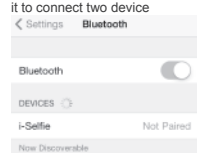

4. Chose "Pair" When LED light stop blinking, the match is finished, iPhone displays

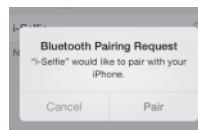

5. Go to iPhone camera, and press the button on **i-Selfie**, which can take a photo by **i-Selfie**.



FCC Compliance and Advisory Statement

This device complies with Part 15 of the FCC rules. Operation is subject to the following two conditions: (1) this device may not cause harmful interference, and (2) this device must accept any interference received, including interference that may cause undesired operation.

This equipment has been tested and found to comply with the limits for a Class B digital device, according to Part 15 of the FCC rules. These limits are designed to provide reasonable protection against harmful interference in a residential installation. This equipment generates, uses and can radiate radio frequency energy and if not installed and used in accordance with the instructions, may cause harmful interference to radio communications. However, there is no guarantee that interference will not occur in a particular installation. If this equipment does cause harmful interference to radio or television reception, which can be determined by turning the equipment off and on, the user is encouraged to try correct the interference by one or more of the following measures:

1. Reorient the receiving antenna.
 2. Increase the separation between the equipment and receiver.
 3. Connect the equipment into an outlet on a circuit different from that to which the receiver is connected.
 4. Consult the dealer or an experienced radio/TV technician for help.
- Any special accessories needed for compliance must be specified in the instruction manual.

Warning: A shielded-type power cord is required in order to meet FCC emission limits and also to prevent interference to the nearby radio and television reception. It is essential that only the supplied power cord be used. Use only shielded cables to connect I/O devices to this equipment.

CAUTION: Any changes or modifications not expressly approved by the party responsible for compliance could void your authority to operate the equipment.