

# Quick Installation Guide

AC2600 Wireless Gigabit VDSL/ADSL Modem Router

*Archer VR2600*

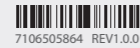

## Connect the Hardware

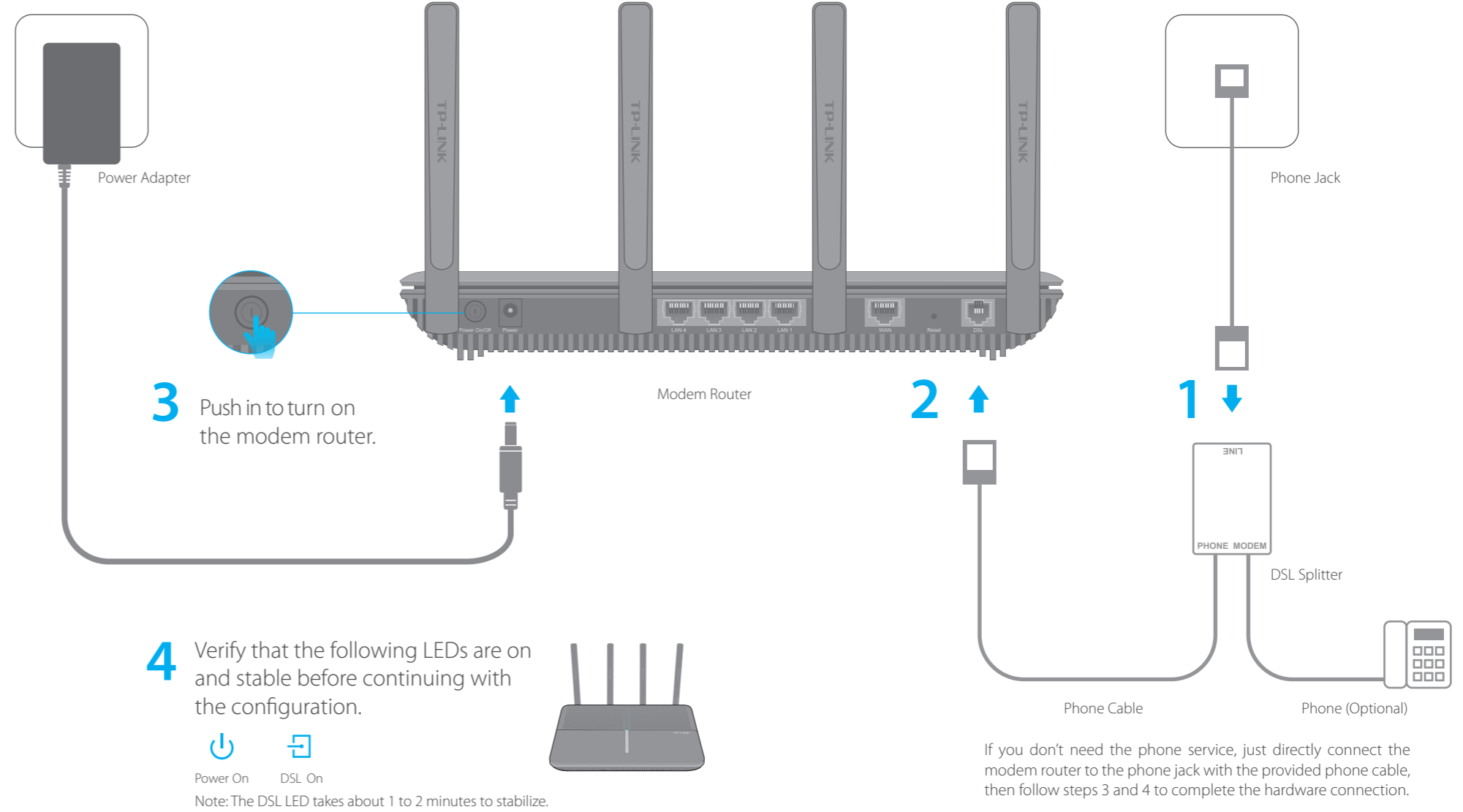

## Configure the Modem Router

**1** Connecting your computer to the modem router via a wired or wireless connection

### Wired

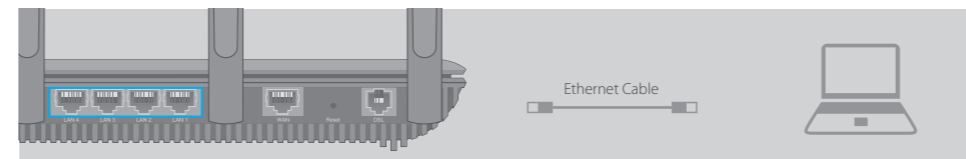

### Wireless

Connect wirelessly by using the SSID (network name) and Wireless Password printed on the product label at the bottom of the modem router.



**2** Configuring the modem router via a web browser

**A** Launch a web browser and type in <http://tplinkmodem.net> or [192.168.1.1](http://192.168.1.1). Create a new password (1-15 characters) and click **Save**.  
Note: If the login page does not appear, please refer to FAQ->Q1.

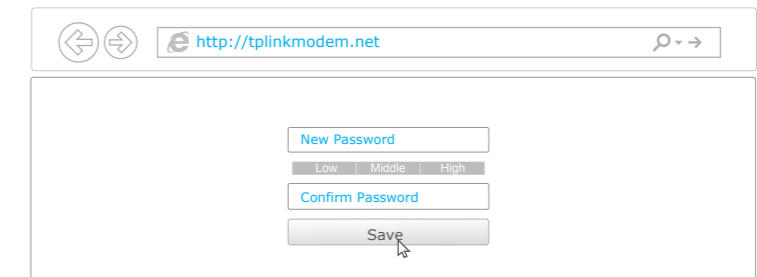

**B** Enter the password you set and click **Log in**.  
Note: For subsequent logins, you only need to enter the password that you have set to log in.

**C** Select your **Region** and **Time Zone**, then click **Next**. Then follow the step-by-step instructions of the Quick Setup to complete the initial configuration.  
Note: Per FCC regulations, all Wi-Fi products marketed in the U.S. must be fixed to the U.S. region only.

## Enjoy the Internet

Now you can enjoy your Internet.  
If you want more advanced settings, please refer to the User Guide on TP-LINK official website at [www.tp-link.com](http://www.tp-link.com).

## Button Legend

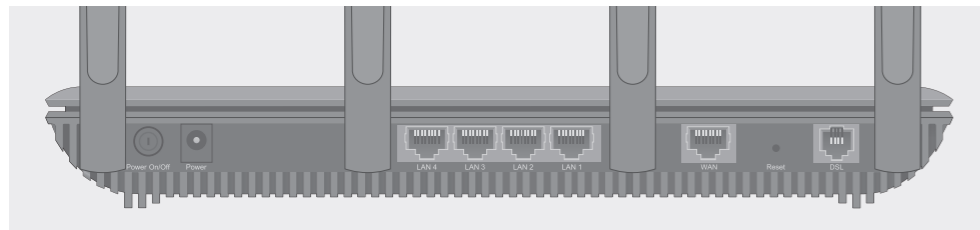

Button	Indication
<b>Power On/Off</b>	Press to power on or off the modem router.
<b>Reset</b>	Press and hold down for 8 seconds to reset the modem router into factory default settings.



Button	Indication
<b>WPS</b>	Press to start a WPS synchronization.
<b>2.4G Wi-Fi</b>	Press to turn 2.4GHz Wi-Fi on or off.
<b>5G Wi-Fi</b>	Press to turn 5GHz Wi-Fi on or off.
<b>LED On/Off</b>	Press to turn all lighted LEDs on or off. LED button is on the front panel, at the end of all LEDs.

## LED Indicators

LED	Status	Indication
<b>Power</b>	On	System initialization complete.
	Flashing	System initializing or firmware upgrading is in process. Do not disconnect or power off the modem router.
	Off	Power is off.
<b>DSL</b>	On	DSL line is synchronized and ready to use.
	Flashing	The DSL negotiation is in progress.
	Off	DSL synchronization failed.
<b>Internet</b>	On	Internet connection is available.
	Off	No Internet connection or the modem router is operating in Bridge mode.
<b>Wireless 2.4GHz</b>	On	The 2.4GHz wireless radio band is enabled.
	Off	The 2.4GHz wireless radio band is disabled.
<b>Wireless 5GHz</b>	On	The 5GHz wireless radio band is enabled.
	Off	The 5GHz wireless radio band is disabled.
<b>LAN</b>	On	At least one LAN port is connected.
	Off	No LAN port is connected.
<b>WPS</b>	On/Off	Turns On when a WPS synchronization is established and automatically turns Off about five minutes later.
	Slow Flashing	A wireless device is trying to connect to the network via WPS. This process may take up to 2 minutes.
<b>USB</b>	On	The inserted USB device is identified and ready to use.
	Flashing	A new USB device is being identified.
	Off	No USB device is plugged into the USB port.

Note: You can turn all lighted LEDs on or off by pressing the LED On/Off button.

## Tether App

To manage your network conveniently on your mobile device, scan the QR code to download the Tether App.



## Features

### • Ethernet WAN Connection

The modem router also supports Ethernet WAN (E-WAN) connection. If you want to use an existing wireless network at home, or switch to the fiber/cable service, you can use the modem router as a wireless router.

To learn more about how to set up Ethernet WAN connection or other connections, please see the User Guide.

### • USB Features

Use the USB ports for media sharing, storage sharing and printer sharing across your local network. You can also setup an FTP server to access your files remotely through the Internet.

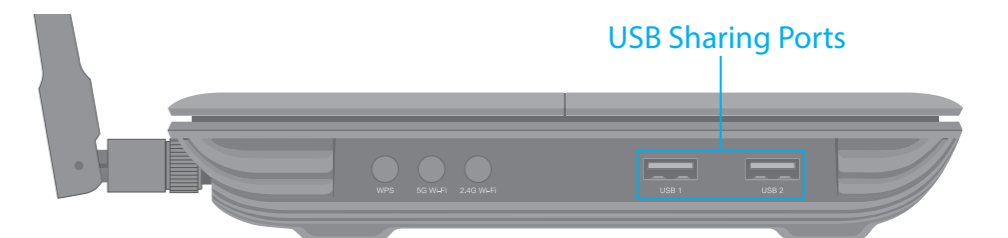

The USB ports can also be used for 3G/4G modem sharing. Insert the 3G/4G USB modem with a SIM/UIM card into one of the USB ports and start sharing your 3G/4G Internet with multiple devices.

To learn more about the USB features, visit <http://tp-link.com/app/usb> or simply scan the QR code.



## FAQ (Frequently Asked Questions)

### Q1. What can I do if the login page does not appear?

- If the computer is set to a static or fixed IP address, change it to obtain an IP address automatically from the modem router.
- Verify <http://tplinkmodem.net> is correctly entered in the web browser and press Enter.
- Use another web browser and try again.
- Reboot your modem router and try again.
- Disable and enable the active network adapter.

### Q2. What can I do if the DSL LED does not turn solid on?

- Check your cables and make sure they are all plugged in correctly, including the telephone lines and power adapter.
- Restore your modem router to its factory default settings.
- Remove the DSL splitter, directly connect the modem router to the phone jack and follow this Quick Installation to reconfigure the modem router.
- Contact your ISP to verify if the DSL line is in good status.
- If you have tried all the suggestions above and the problem still exists, contact our Technical Support.

### Q3. What can I do if I cannot access the Internet?

- Make sure the telephone and Ethernet cables are plugged in correctly.
- Try to log into the web management page of the modem router using the default address at <http://tplinkmodem.net>. If you can, try the following answers. If you cannot, change your computer to obtain an IP address automatically from the modem router.
- Consult your ISP and make sure all the VPI/VCI (or VLAN ID), Connection Type, account username and password are correct. If they are not, please replace them with the correct settings and try again.
- Restore the modem router to its factory default settings and reconfigure the modem router by following the instructions in this Quick Installation Guide.
- Please contact our Technical Support if the problem still exists.

### Q4. What can I do if I forget my password?

- Web Management page password:**  
Restore the modem router to its factory default settings and then set a new password using 1-15 characters.
- Wireless Network password:**  
A1. The default Wireless Password/PIN is printed on the product label of the modem router.

- If the default wireless password has been changed, log into the modem router's web management page and go to **Basic > Wireless** to retrieve or reset your password.

### Q5. How do I restore the modem router to its factory default settings?

- With the modem router powered on, press and hold down the **Reset** button on the rear panel of the modem router for 8 seconds until all LEDs turn back on momentarily, then release the button.
- Log in Web Management page of the modem router, and go to **Advanced > System Tools > Backup & Restore**, click **Factory Restore** and wait until the reset process is complete.

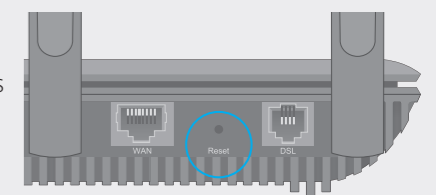

Reset Button Press & Hold for 8 seconds