

RC71 remote control for HR44 and C41 models

Using the RC71 remote control

Most remote controls work by sending an infra-red (IR) signal to your DIRECTV® Receiver and you must point them directly at your DIRECTV® Receiver for them to work.

The RC71 remote control has been factory-set to work in this way, but you can program it to control your HR44 DIRECTV® Receiver or C41 DIRECTV® Receiver using a radio-frequency (RF) signal instead. This means that you do not have to point the remote control directly at your DIRECTV® Receiver for it to work.

During the programming process, the RC71 remote control becomes paired with a specific DIRECTV® Receiver.

You can, however, later pair it with a different DIRECTV® Receiver instead, if you wish.

You can also reset your remote control to revert to working by means of IR. You need to do this first, if you wish to pair your remote control with a different DIRECTV® Receiver.

You program for RF and reset using on-screen menus, which give you instructions. The green light on the RC71 remote control flashes at key stages during programming and reset.

Buttons you use to program and reset the RC71 remote control

Green light that flashes when you program the remote control

SELECT button

MUTE button

CH Channel up/down button (rocker switch)

ENTER button



RC71 remote control for HR44 and C41 models (cont.)

Programming your RC71 remote control to use RF

Starting from a TV picture, point your RC71 remote control at your DIRECTV® Receiver and press **MENU**.

Select **Settings and Help**, then select **Settings**.

Select **Remote Control**.

Select **IR/RF Setup**.

Use the arrow buttons to highlight **IR**, then press **SELECT**.

Use the arrow buttons to highlight **RF**, then press **SELECT**.

Use the right arrow button to highlight **Continue**, then press **SELECT**.

Hold down both the **MUTE** button and the **SELECT** button until the green light on the RC71 remote control flashes two times.

In quick succession, press the following buttons: **9**, then **6**, then **1**, then **CH (up)**, then **ENTER**.

The green light on the RC71 remote control flashes four times to show you have successfully programmed your RC71 remote control and paired it with your DIRECTV® Receiver.

2 Select **Done** to complete the pairing process.

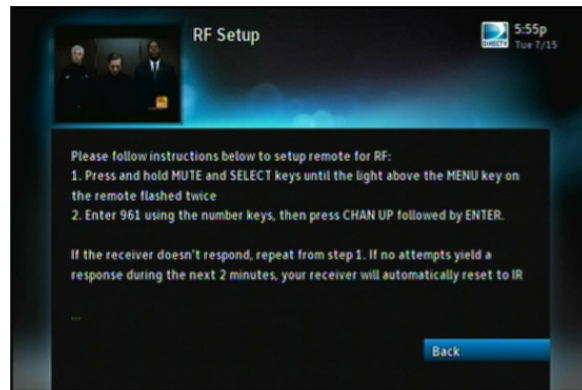

RC71 remote control for HR44 and C41 models (cont.)

Resetting your RC71 remote control to use IR

If you are resetting at the DIRECTV® Receiver your remote control is currently paired with, you use on-screen menus.

Starting from a TV picture, press **MENU**.

Select **Settings and Help**, then **Remote Control**, then **Reset Remote**.

Hold down both the **MUTE button and the **SELECT** button until the green light on your RC71 remote control flashes two times.

In quick succession, press the following buttons:
9, then **8**, then **1**.

The green light on your RC71 remote control flashes four times to show you have successfully reset your RC71 remote control to its factory settings.

Select **Done** to complete the resetting process.

Your RC71 remote control now works using IR, so you have to point it directly at your DIRECTV® Receiver to use it.

** If you want to reset your remote control at a receiver it is not currently paired with, begin the resetting process at point ** above.

