

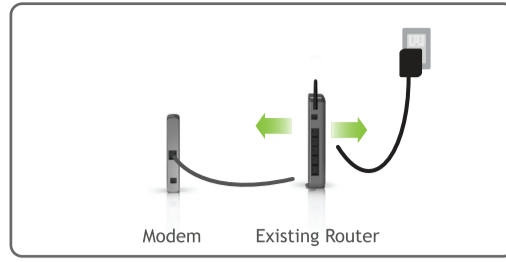

1 Disconnect and Power Off your Existing Router (if you have one)

Disconnect your existing router from your computer, your broadband modem and its power outlet. If you do not have an existing router please continue to Step 2.



2 Power Off your Modem

Power off the Modem by disconnecting the Modem's power adapter from the power outlet. If your Modem has a backup battery, remove the backup battery from your Modem.

Do NOT power on your Modem until Step 4.

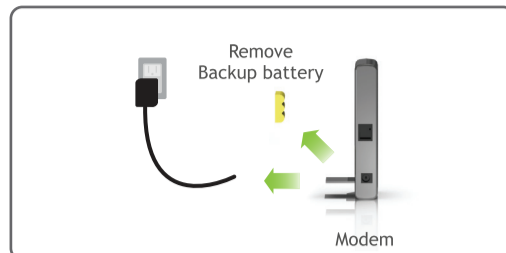

3 Connect the High Power Router to your Modem

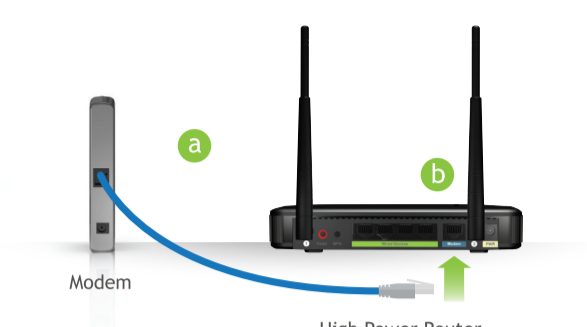

- a Use the included blue Ethernet cable and connect one end of the cable to your Modem.
- b Connect the other end of the cable to the blue **Modem** port on the High Power Router.

Do NOT connect the power adapter to the High Power Router at this time.

4 Power on your Modem

Plug in the power adapter and reinsert the backup battery (if available) to power on the Modem.

Allow a minute or two for the Modem to initiate.

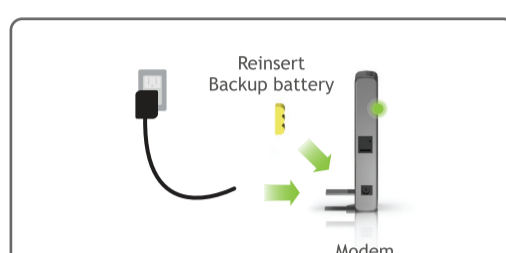

5 Power On the High Power Router and Connect it to your Computer

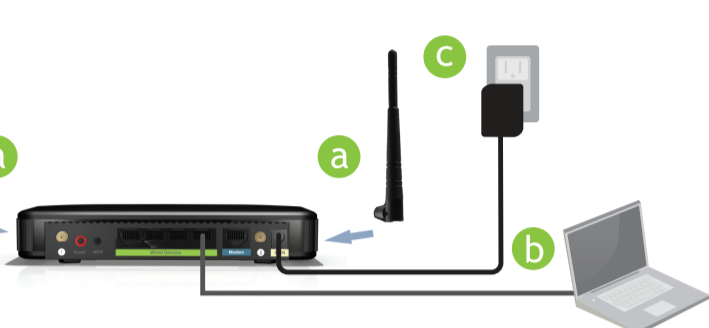

- a Attach the two included Antennas.
- b Connect the included grey Ethernet cable to an available network port on your computer.
- c Attach the Power Adapter to the High Power Router's **PWR** port and a power outlet.

6 Open your Web Browser

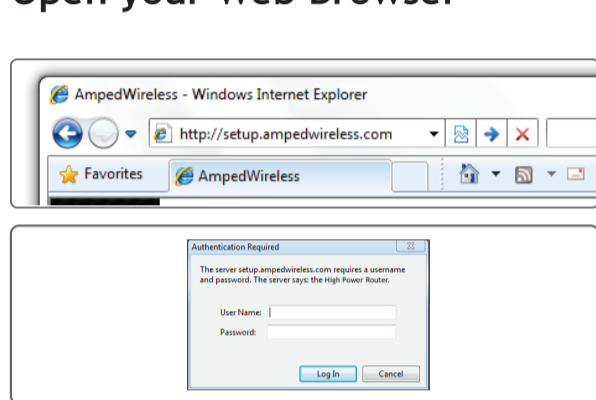

Enter the setup web address into your browser:

<http://setup.ampedwireless.com>

If the URL fails to open, then try: <http://192.168.3.1>

When prompted enter the login and password:

LOGIN: admin
PASSWORD: admin

IF YOU HAVE PROBLEMS ACCESSING THE WEB MENU...

Disable any third party firewalls that your computer may have on (i.e. Norton/Symantec/Windows). Check to see that your computer is NOT connected to any wireless networks.

Accessing the setup menu does not require Internet access. The menu is served from the Router.

7 Welcome to the Smart Setup Wizard

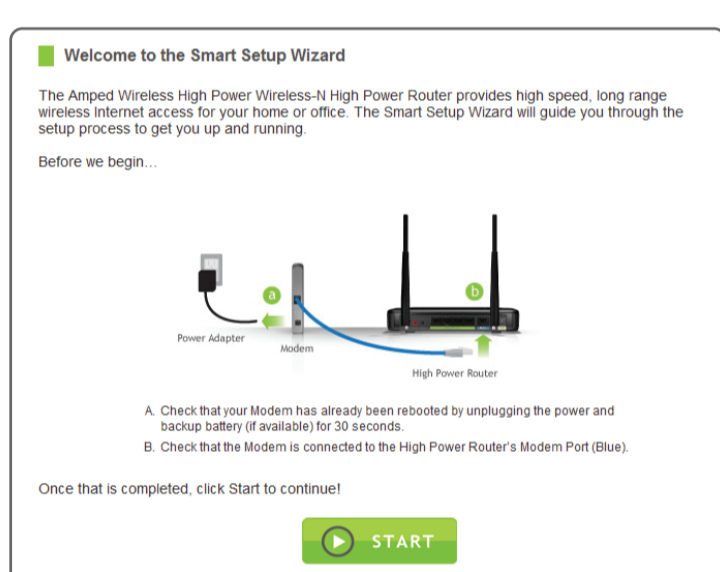

The Smart Setup Wizard will guide you through the following settings:

- 1 Internet Connection Settings
- 2 System Clock
- 3 Wireless Settings

Click **Start** to begin.

8 Configure your Internet Connection

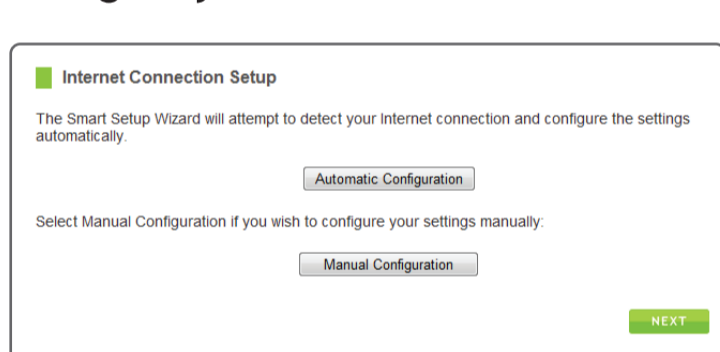

Configure your Internet settings using the automatic settings.

More advanced users may choose to configure their connection manually by selecting Manual Configuration.

If your Internet provider requires that you login before accessing the Internet you will need to do so under Manual Configuration.

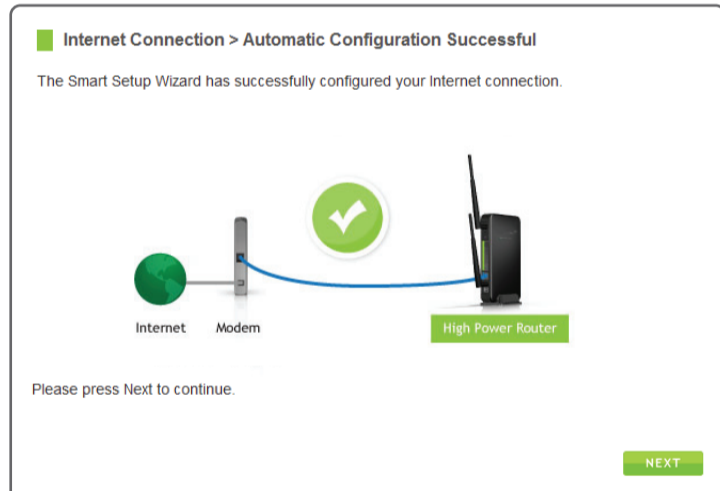

If there is a problem with the Automatic Configuration, the wizard will notify you of the issue. If you continue to have problems, contact our support department at 888-573-8820.

If the Automatic Configuration was successful, you will be directed to a Configuration Successful page.

Click **Next** to continue.

9 Set the System Clock

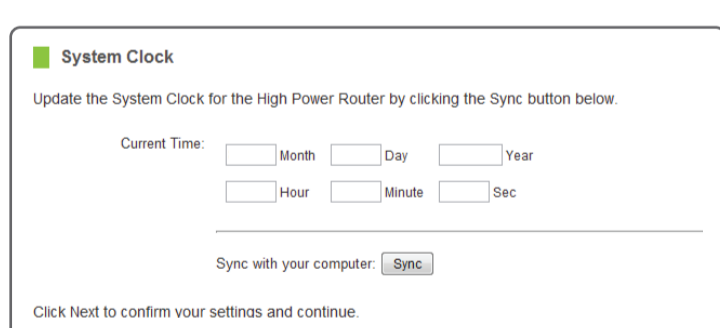

The System Clock is used for system logs and setting schedules for Internet access. Click **Sync** to synchronize the System Clock with the time on your computer.

Click **Next** to continue.

10 Configure your Wireless Settings

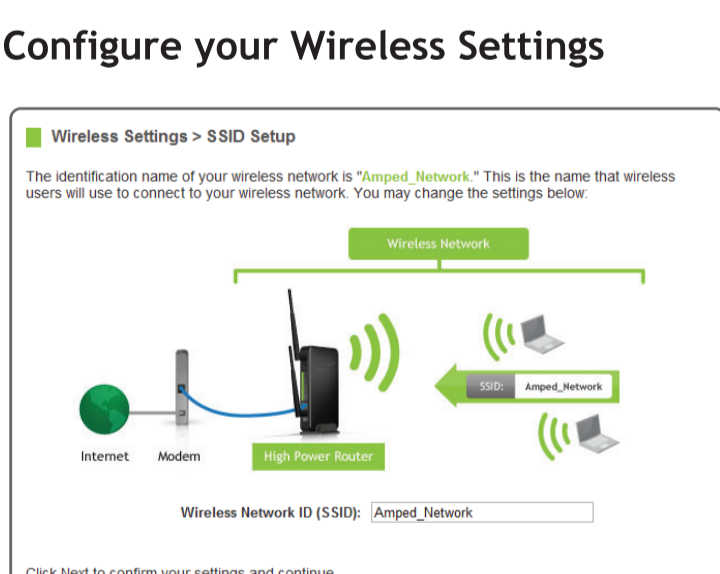

The default ID of your wireless network is:

Amped_Network

To change it, enter a new name in the SSID field. Users connecting wirelessly to the Router will use this ID to identify your wireless network.

Click **Next** to continue.

11 Wireless Security Settings

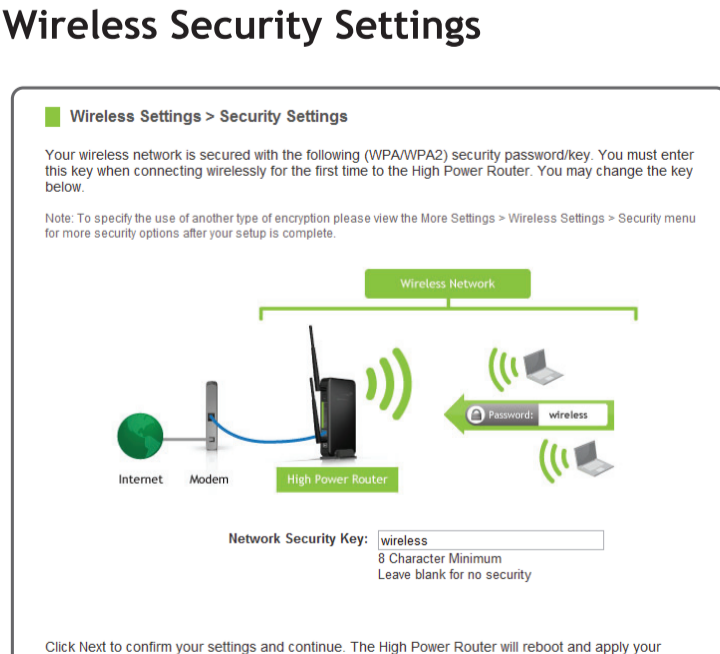

The default Security Key (WPA/WPA2) of your wireless network is: **wireless**

To change it, enter a new key in the Security Key field. The key must be at least 8 characters long.

Click **Next** to apply your settings. The High Power Router will reboot. This process may take up to 1 minute. The page will automatically reload after the countdown. If it does not, you may need to refresh the page manually or check your connection to the router.

12 Setup Summary

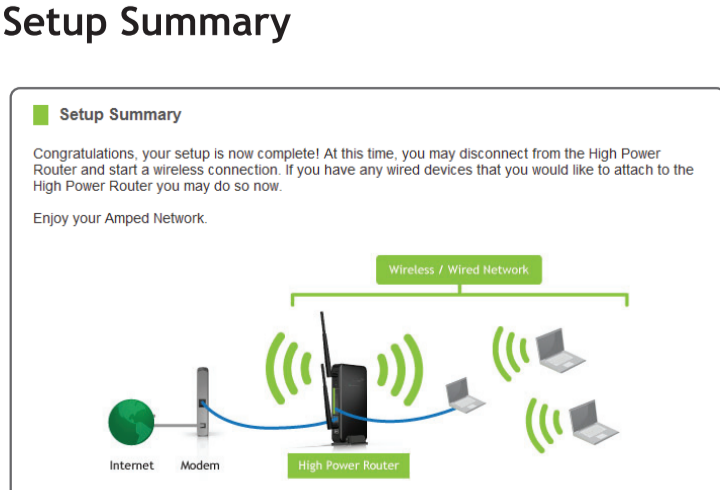

Congratulations, the High Power Router is now successfully configured, and your settings are now saved. You may now connect additional devices directly to the 4 wired ports on the back panel, or connect wirelessly to the High Power Router.

If you experience any problems at any point during the Setup Wizard process, please contact Amped Wireless Technical Support. We're here to help:

Phone: **888-573-8820**
Email: techsupport@ampedwireless.com
Web: www.ampedwireless.com/support

LED Indicator Information

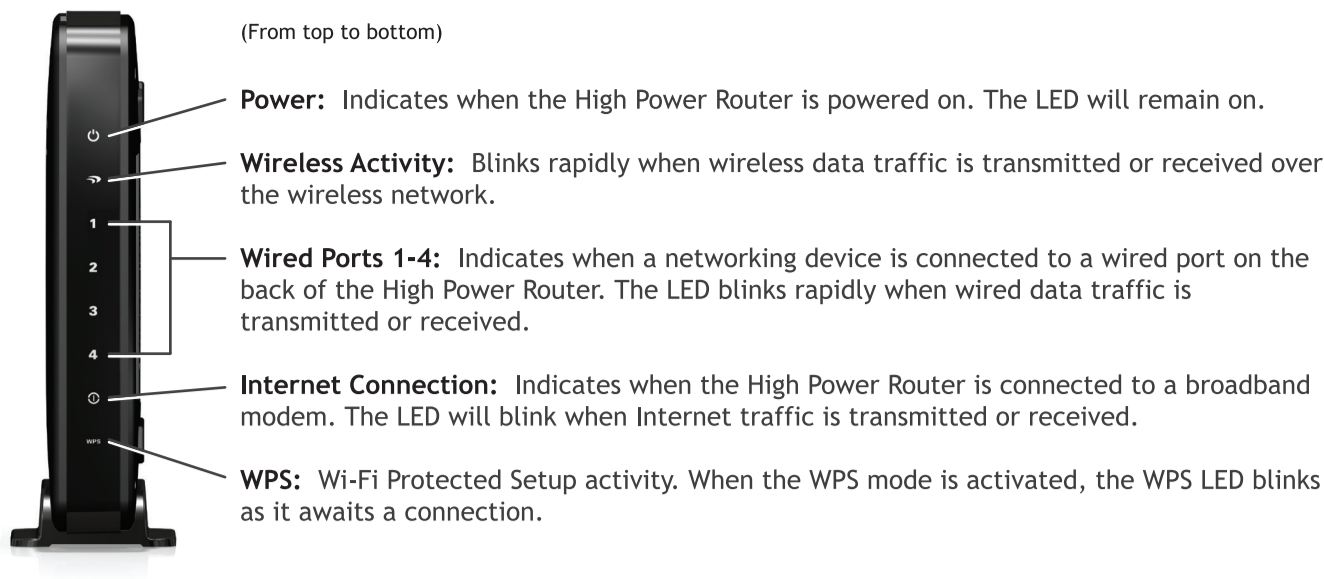

How to Connect Wirelessly to the High Power Router:

Windows 7 and Vista

A. Click on the Wireless icon to see available wireless networks (For Vista, click Start > Connect To). Select the "Amped_Network" network and click **Connect**.

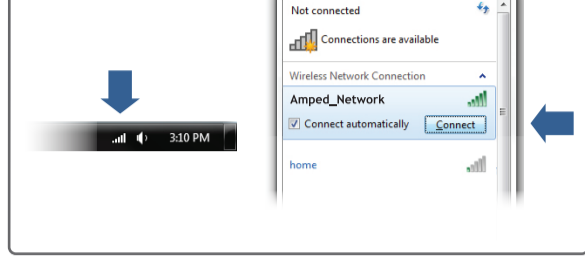

B. When prompted, enter the wireless security key "wireless" and click **OK**.

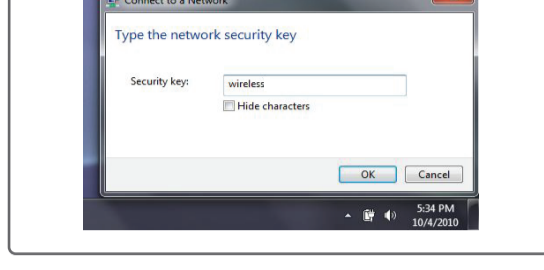

Mac OS X

A. Click on the Wireless icon to see available wireless networks. Select the "Amped_Network" network and click **Connect**.

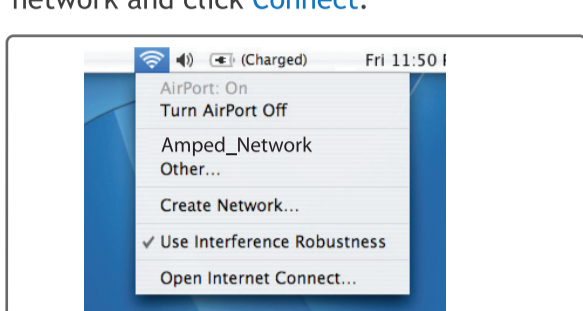

B. When prompted, enter the wireless security key "wireless" and click **OK**.

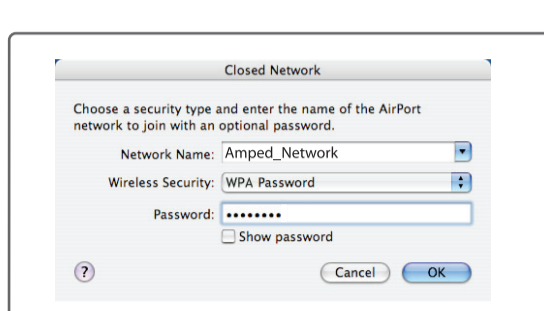

iPad Tablet

- Tap the "Home" button to get to the home page.
- Tap the "Settings" app icon.
- Tap on Wi-Fi to enter the iPad's Wi-Fi settings.
- Touch the "On/Off" selector switch to "On"
- Under "Choose a Network" select: "Amped_Network"
- When prompted, enter the wireless security key: "wireless"

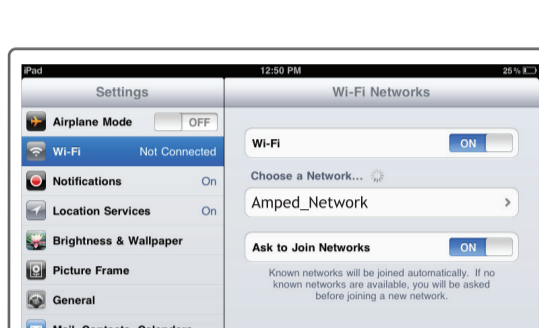

Android Tablet

- Tap the "Apps" menu on the tablet screen.
- Locate and tap the "Settings" app icon.
- Under "Wireless & Networks" tap "Wi-Fi settings"
- Tap the Wi-Fi box to turn on Wi-Fi and scan.
- Under "Wi-Fi Networks" select: "Amped_Network"
- When prompted, enter the Password key: "wireless"

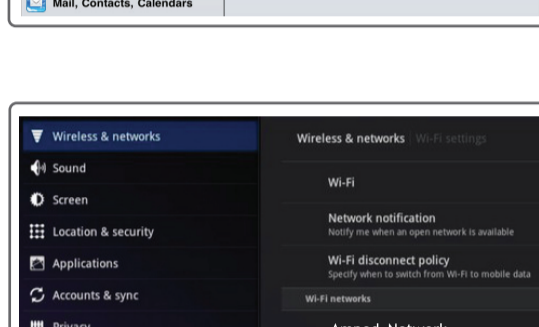

Wi-Fi Protected Setup (One-Touch Setup or Push Button Configuration)

If your Wi-Fi device has WPS one-touch setup you can use it to connect to the High Power Router:

- Hold down the WPS button on the High Power Router (back panel) for 3 seconds. The WPS LED will begin to blink.
- As it blinks, push the WPS button on your wireless adapter or enable WPS with the provided software for your wireless adapter. WPS will automatically configure the connection settings for your wireless adapter to connect to the High Power Router.



Setting a Login and Password

The High Power Router has a default login and password to access the web menu:

LOGIN: admin
PASSWORD: admin

This login/password is NOT the wireless network key used to connect to your wireless network.

It is strongly recommended that you change these settings and select your own personal login and password. The Password menu can be accessed through the web menu under **More Settings > Management > Password** on the left side of the web menu.

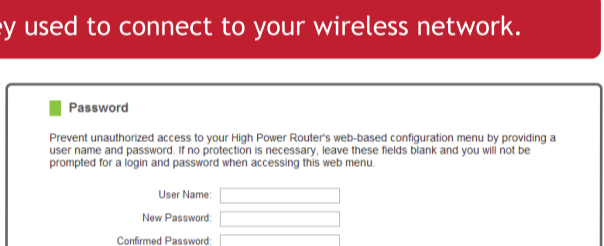

If you forget your login and password, you will need to reset the High Power Router back to default settings and use the default login and password (login: admin, password: admin) to access the web menu. View the instructions below on how to reset your High Power Router back to default settings.

Using the Features on the High Power Router

The High Power Router is equipped with many powerful security features which can be accessed through the web menu under **Smart Features**, **Firewall Settings** and **Quality of Service** on the left side of the web menu:

<p>Web Menu (Left Side)</p>	<p>Wireless Access Scheduling Control when your Wi-Fi is on/off Menu Location: Smart Features > Access Schedule</p>
	<p>User Access Control (Mac/IP) Restrict network access to specific users Menu Location: Smart Features > User Access</p>
	<p>Wireless Coverage Control Adjust the distance of your wireless network Menu Location: Smart Features > Wireless Coverage</p>
	<p>Block Websites Prevent access to specific websites Menu Location: Smart Features > Block Websites</p>
	<p>Firewall Settings Protect your network from outside intruders Menu Location: Firewall Settings</p>
	<p>Quality of Service (Prioritize Bandwidth) Manage your network bandwidth Menu Location: Quality of Service</p>

If you are unfamiliar or want more information on how to set up Smart Features, Firewall Settings, Quality of Service, please refer to the User's Guide on the included CD.

How to Reset the High Power Router to Default Settings

There are two options to reset the High Power Router back to factory default settings:

- Access the **Reset** button through the web menu under **More Settings > Management > Save/Reload Settings** on the left side of the web menu. Select the **Reset Settings to Default**.
- Access the physical **Reset Button** on the back panel of the High Power Router:

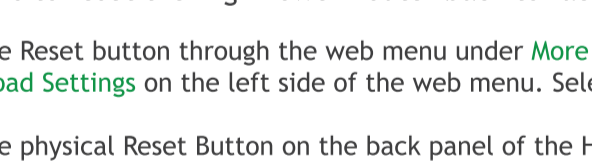

Hold down the Reset Button for five to ten (5-10) seconds. You may need to use a pen tip or pin to access the button. Pressing the Reset Button for less than five (5) seconds will simply reboot the High Power Router while saving your existing settings.

Troubleshooting Tips

- PROBLEM:** I entered setup.ampedwireless.com and it failed to open the Web Menu.
- SOLUTIONS:**
- Make sure your computer is connected to the High Power Router using the included Ethernet cable. Ensure that the power on the High Power Router is on.
 - Check that your computer IS NOT connected to any wireless networks. If it is, disable your Wi-Fi connection and disconnect from all wireless networks. Reboot the router and try again.
 - Close your current web browser and reopen it. Use Google Chrome or Internet Explorer (8.0 and up)
 - Open your web browser and enter 192.168.3.1 into the web address bar.
 - Reset the High Power Router to default settings by holding the Reset Button (located on the back panel) for ten (10) seconds and try again.
-
- PROBLEM:** I am having problems with features on the Web Menu. When clicking buttons, it does not register my action.
- SOLUTION:**
- Check that you are using a supported web browser: Google Chrome, Internet Explorer (8.0 and up) and Safari. If you are using an unsupported web browser, such as Firefox, please change to one of the supported web browsers and try again.
-
- PROBLEM:** I have a DSL connection and I am not able to access the Internet through the High Power Router.
- SOLUTION:**
- Your Internet provider may require that you enter your login information to access the Internet. To enter your information, go to Manual Configuration from the Smart Setup Wizard and access the PPPoE menu from the dropdown menu. Enter the required login information for your Internet provider.
-
- PROBLEM:** The Smart Setup Wizard could not automatically configure my Internet connection.
- SOLUTIONS:**
- Reset your Modem by holding down the reset button located on the back of the Modem for approximately 5 seconds. Try again.
 - Reboot the High Power Router by unplugging the power adapter and plugging it back in.
 - Static IP: Your Internet provider may require a static IP setting. Check with your ISP to obtain the IP settings.
 - DSL Connection: Your Internet connection may require login information. If you are using PPPoE mode, you will need to manually configure your Internet connection settings and obtain your username and password.
 - Cable Modem: Your Internet connection may require you to Clone your MAC address. Go to More Settings > IP Settings > Internet Network (WAN) and select Automatic/Dynamic (DHCP) from the dropdown menu. Clone your PC's MAC address under the DNS settings.
-
- PROBLEM:** I am not getting maximum signal strength on my wireless signal display when connecting to the High Power Router.
- SOLUTIONS:**
- Step back at least 10 feet from the High Power Router and check your signal again. The High Power Router emits high power, long range Wi-Fi signals that may confuse your wireless adapter signal reading at close range. The speed and signal are at 100%, however, your wireless network adapter reconfiguration may not be displaying correctly.
 - Change the wireless channel on the High Power Router to 11 or 1 and try again. There may be wireless interference in your installation environment.
-
- PROBLEM:** My computer is getting an IP address of 169.254.x.x and/or Windows networking says I have "Limited or no Connectivity."
- SOLUTIONS:**
- Make sure the High Power Router is powered on.
 - Check that your computer's network adapter is enabled and is set to "Obtain IP Address Automatically"
 - Restart your computer and try again.
 - You may have a faulty network port. Try connecting to the High Power Router from another computer or using the wireless connection on your computer, if possible.

If you continue to have issues setting up the High Power Router, give us a call – we're here to help: 888-573-8820
Visit our website for more support information and answers to frequently asked questions: www.ampedwireless.com/support

Federal Communication Commission Interference Statement

This equipment has been tested and found to comply with the limits for a Class B digital device, pursuant to Part 15 of the FCC Rules. These limits are designed to provide reasonable protection against harmful interference in a residential installation. This equipment generates, uses, and can radiate radio frequency energy and, if not installed and used in accordance with the instructions, may cause harmful interference to radio communications. However, there is no guarantee that interference will not occur in a particular installation. If this equipment does cause harmful interference to radio or television reception, which can be determined by turning the equipment off and on, the user is encouraged to try to correct the interference by one or more of the following measures:

- Reorient or relocate the receiving antenna.
- Increase the separation between the equipment and receiver.
- Connect the equipment into an outlet on a circuit different from that to which the receiver is connected.
- Consult the dealer or an experienced radio/TV technician for help.

FCC Caution:

This device complies with Part 15 of the FCC Rules. Operation is subject to the following two conditions: (1) This device may not cause harmful interference, and (2) this device must accept any interference received, including interference that may cause undesired operation.

RF Radiation Exposure and Hazard Statement:

To ensure compliance with FCC RF exposure requirements, this device must be installed in a location such that the antenna of the device will be greater than 20 cm (8 in.) away from all persons. Using higher gain antennas and types of antennas not covered under the FCC certification of this product is not allowed. Installers of the radio and end users of the product must adhere to the installation instructions provided in this manual. This transmitter must not be co-located or operating in conjunction with any other antenna or transmitter.

Non-modification Statement:

Use only the integral antenna supplied by the manufacturer when operating this device. Unauthorized antennas, modifications, or attachments could damage the TI Navigator access point and violate FCC regulations. Any changes or modifications not expressly approved by the party responsible for compliance could void the user's authority to operate this equipment.

Deployment Statement:

This product is certified for indoor deployment only. Do not install or use this product outdoors.