

1

2

3

4

Remark	Description	Editor	Date

### NOTES(技术要求):

- 1.Dimension after folding(折叠后尺寸): 144\*184mm.
- 2.Print colour(印刷颜色): 4 colour printing(4色印刷).
- 3.Material(材质): 105g copperplate paper(105g铜版纸).
- 4.Coating(表面处理): Varnishing(双面过光油).
- 5.Binding process(装订工艺): Paper folding(折页)——对折
- 6.Output Ipi(输出网线): 200 Ipi.
- 7.Tolerance(公差): L(长)\*W(宽): ±1mm.
- 8.Raw materials and the corresponding post processing should meet requirements defined in the T&W Environmental Protection Technical Standards. (原材料及后处理工艺均能满足我司《环保技术标准》要求).

切线, 不印刷      折痕线, 不印刷      C:0 M:100 Y:100 K:0

**FCC Statement**

This equipment has been tested and found to comply with the limits for a Class B digital device, pursuant to part 15 of the FCC Rules. These limits are designed to provide reasonable protection against harmful interference in a residential installation. This equipment generates, uses and can radiate radio frequency energy and, if not installed and used in accordance with the instructions, may cause harmful interference to radio communications. However, there is no guarantee that interference will not occur in a particular installation. If this equipment does cause harmful interference to radio or television reception, which can be determined by turning the equipment off and on, the user is encouraged to try to correct the interference by one or more of the following measures:

- Reorient or relocate the receiving antenna.
- Increase the separation between the equipment and receiver.
- Connect the equipment into an outlet on a circuit different from that to which the receiver is connected.
- Consult the dealer or an experienced radio/TV technician for help.

**FCC Radiation Exposure Statement**

This device complies with FCC radiation exposure limits set forth for an uncontrolled environment and it also complies with Part 15 of the FCC RF Rules. This equipment must be installed and operated in accordance with provided instructions and the antenna(s) used for this transmitter must be installed to provide a separation distance of at least 20 cm from all persons and must not be co-located or operating in conjunction with any other antenna or transmitter. End-users and installers must be provided with antenna installation instructions and consider removing the no-collocation statement.

This device complies with Part 15 of the FCC Rules. Operation is subject to the following two conditions:

(1) this device may not cause harmful interference, and

(2) this device must accept any interference received, including interference that may cause undesired operation.

**Caution!**

Any changes or modifications not expressly approved by the party responsible for compliance could void the user's authority to operate the equipment.

**zNID-24xxB1 Quick Installation Instructions**

Document Number: 830-04306-01  
June 2018

**Installation**

**1. Mounting**  
The zNID-24xxB1 has a stand that can be removed and used for a mounting bracket.

**Wall mount:**

- Prepare the surface for mounting and mark wall on a level horizontal line 124mm apart (a little more than 4.78 inches). Since there is very little leeway it is best to use the mounting bracket as a template.
- Drill the holes and attach screws appropriate for the surface, leaving enough space from being flush to mount unit.
- Mount the unit.

**2. Connect to the network**

- Remove the protective cap of the optical port.
- Connect an optic cable with proper optical connector to the port.
- Thread the optic cable in the fiber channel.

**3. Connect telephone (POTS) service**

- Plug the lead from the telephone into one of the POTS ports. Repeat step a to connect additional phone lines.

**4. Connect Ethernet service**

All zNID-24xxB1 have four Gigabit Ethernet ports.

- Locate the premises' Ethernet LAN cable.
- If the cable is not terminated, follow local practices to attach an RJ-45 connector.
- Plug the Ethernet cable into the zNID RJ-45 Ethernet port.
- Repeat steps b-c as needed to connect additional Ethernet cables.

**5. Connect USB**

The USB 2.0 port is provided for future applications.

**6. Connect power**

The zNID has a DC power supply power connection and an uninterruptible power supply (UPS) power connection. **NOTE:** that the UPS and DC power connections **MUST NOT** be used at the same time.

**If using DC power supply**

- Plug the round two-pin DC power connector of the DC power supply into the zNID DC power port.
- Plug the DC power supply into a live AC outlet.
- Verify that the POWER LED on the zNID is solid green indicating local power is on and voltage is good. See the LED descriptions for a complete description of the LEDs.

**If using UPS power:**

- Plug the UPS connector into the zNID.

**7. Logging in locally to the zNID**

The zNID 24xxB series may be managed from ZMS, OMC, Web UI or CLI. This section describes logging into the zNID locally using the subscriber-facing LAN port (GE1).

- Connect an Ethernet cable from your computer to GE1 on the zNID.
- Launch a browser or telnet session and direct it to 192.168.1.1.
- Enter the username and password.

The default username/password is admin/admin. For security the password should be changed as described in the zNID Configuration Guide available at dasanzhonetech.com.

Copyright © 2018 DASAN Zhone Solutions      Document Number: 830-04306-01

对应客户文档的page 1

**UPS Connector Pinouts**

Below are the pin outs for the UPS connector. **Note:** the UPS and DC power connections **MUST NOT** be used at the same time.

Pin	Signal	Comments
1	+VDC	Power in from UPS
2	-VDC	Power return to UPS
3	On Battery	Open signal when on battery power
4	Signal Return	Connected to Signal GND on ONT
5	Missing Battery	Open signal when battery not detected
6	Replace Battery	Open signal when battery should be replaced
7	GND	Connected to Signal GND on ONT
8	Low Battery	Open signal when battery is low

For more information on pinouts, please see the zNID 24xxA1 Hardware Installation Guide available at zhonetech.com

**ONT Power Requirements**

- 12VDC
- 18W max
- 1.5A max

**WARNING!** Using a power supply not meeting these requirements may result in system damage, overheating, or even fire.

**ATTENTION!** L'utilisation d'une source d'alimentation électrique qui ne répond pas à ces exigences peut résulter dans des dommages du système, une surchauffe, ou même un incendie.

**Supported models**

For more information, please see the zNID 24xxA1 Hardware Installation Guide available at zhonetech.com

Model	Description
ZNID-GPON-2428B1	GPON Uplink, 2 POTS, 4 GgE, 2x2 2.4GHz 802.11n/gh, 1 USB port
ZNID-GPON-2428B1	GPON Uplink, 2 POTS, 4 GgE, 2x2 2.4GHz 802.11n/gh and 3x3 5.8GHz 802.11n/ac, 1 USB port
ZNID-GE-2428B1	GE Uplink, 2 POTS, 4 GgE, 2x2 2.4GHz 802.11n/gh, 1 USB port
ZNID-GE-2428B1	GE Uplink, 2 POTS, 4 GgE, 2x2 2.4GHz 802.11n/gh and 3x3 5.8GHz 802.11n/ac, 1 USB port

**zNID Status LEDs**

LED Name	Color	Behavior	Indicates
Heartbeat	Green	Heartbeat blink (1 short blink every 5 seconds)	Normal Operation
Rapid Blink	Green	Rapid Blink (10/sec)	Unit has been reset to Factory Defaults / is unconfigured
STATUS	Green	50% cycle: 1 sec Rapid Blink / 1 sec OFF	System booting
Green	Green	Show Blink (1 / 1 sec)	Remote Mgt Access (SNMP, HTTP, Telnet, or TR-069)
Green	Green	Solid On	Reboot or reset in process
None	None	None	Power off
BATT	Yellow	Solid On	Operating on Battery Power
Yellow	Yellow	Slow Blink (2 / 1 sec)	Battery Alarm (Low Battery, Missing, or Replace)
None	None	None	Normal operation on DC power supply
ALARM	Red	Solid On	Major Alarm
Red	Red	50% cycle: 1 sec Rapid Blink / 1 sec OFF	EZ Touch actions pending — SW or Config update required
None	None	None	No Major Alarm
WAN	Green	Solid On	Ranged successfully
Green	Green	Flash	Ranging in progress
None	None	None	Not ready for ranging or not provisioned
INTERNET	Green	Solid On	EZ Touch configuration is complete
Green	Green	Rapid Blink (10 / 1 sec)	EZ Touch provisioning in progress
None	None	None	No EZ Touch provisioning was performed
None	None	None	Internet service is available
None	None	None	Internet service is unavailable (no response from DNS server)
None	None	None	Ethernet interface wired
None	None	None	Ethernet interface wired
None	None	None	Data transmitting
None	None	None	Ethernet interface not linked
None	None	None	Registration successful
None	None	None	Off hook
None	None	None	Registration failed or telephone service is not provisioned
None	None	None	Connected
None	None	None	No power/USB not connected
None	None	None	2.4GHz WiFi service is enabled on ONT
None	None	None	2.4GHz WiFi data passing between ONT and connected device
None	None	None	2.4GHz WiFi service is disabled on ONT
None	None	None	5.8GHz WiFi service is enabled on ONT
None	None	None	5.8GHz WiFi data passing between ONT and connected device
None	None	None	5.8GHz WiFi service is disabled on ONT

**NOTE:** Slots and openings in the housing are provided for ventilation. To ensure reliable operation of the product and to protect it from overheating, these slots and openings must not be blocked or covered. This unit is also certified to operate effectively under the following conditions: Operating Temperature: 20° F to 122° F (0° C to 50° C). Do not look into the ends of optical fibers. Exposure to invisible LASER radiation may cause serious retinal damage or even blindness. Verify the optical source is disabled through the use of an optical power meter before handling optical fibers. This product may contain copyrighted software that is licensed under the GNU General Public License (GPL), a copy of which is available at www.gnu.org/licenses. You may obtain a copy of such software, in source code form, from Zhone for a period of three years after our last shipment of the product by following the instructions at www.zhone.com/gpl.

Copyright © 2018 DASAN Zhone Solutions      Document Number: 830-04306-01

对应客户文档的page 2

对应客户文档的page 3

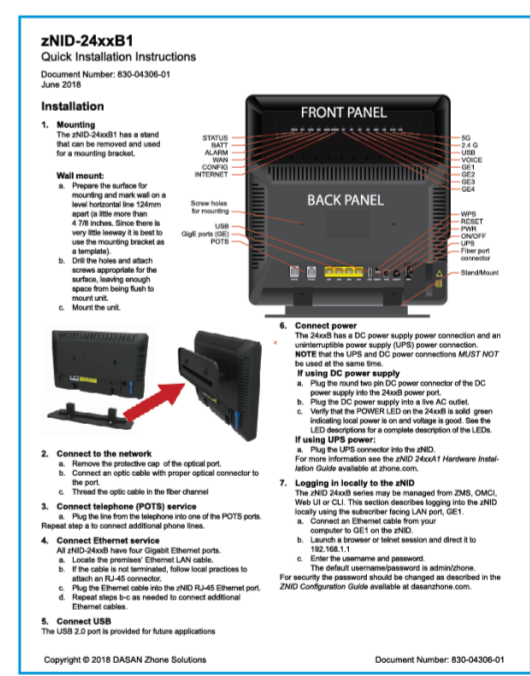

成品图

DIM	TOL±				CUSTOMER: <b>Zhone</b>	<b>T&amp;W 同维</b> SHENZHEN GONGJIN TELECOM TECHNOLOGY CO.,LTD.				
	RANGE	C1	C2	C3						C4
0~6	0.1	0.1	0.15	0.2	TITLE: 快速安装指南	MODEL: ZNID-GPON-2428B1			PART NO:	
6~30	0.2	0.3	0.4	0.5						
30~80	0.25	0.5	0.9	1.2	UNITS	mm	VER:	V01	DRAW	DATE:
80~180	0.3	0.8	1.2	1.5	MAT'L	/	SCALE	N/A	CHECK	
180~315	0.5	1.3	1.8	3	FINISH	/	SHEET	1 / 1	PDE	N/A
315~500	0.7	1.5	2.5	4						
500~800	0.9	1.8	3	5						
ANG.TOL±	0°~30°/0.1°	30°~60°/0.3°	60°~90°/0.5°							

1

2

3

4