

Quick Start Guide

REV.E1

This device complies with Part 15 of the FCC rules. Operation is subject to the following two conditions: (1) this device may not cause harmful interference, and (2) this device must accept any interference received, including interference that may cause undesired operation.

The manufacturer is not responsible for any radio or TV interference caused by unauthorized modifications or change to this equipment. Such modifications or change could void the user's authority to operate the equipment.

This equipment has been tested and found to comply with the limits for a Class B digital device, pursuant to part 15 of the FCC Rules. These limits are designed to provide reasonable protection against harmful interference in a residential installation. This equipment generates, uses and can radiate radio frequency energy and, if not installed and used in accordance with the instructions, may cause harmful interference to radio communications. However, there is no guarantee that interference will not occur in a particular installation. If this equipment does cause harmful interference to radio or television reception, which can be determined by turning the equipment off and on, the user is encouraged to try to correct the interference by one or more of the following measures:

- Reorient or relocate the receiving antenna.
- Increase the separation between the equipment and receiver.
- Connect the equipment into an outlet on a circuit different from that to which the receiver is connected.
- Consult the dealer or an experienced radio/TV technician for help.

To maintain compliance with FCC's RF exposure guidelines, this equipment should be installed and operated with a minimum distance of 20cm between the radiator and your body.

Hardware Overview

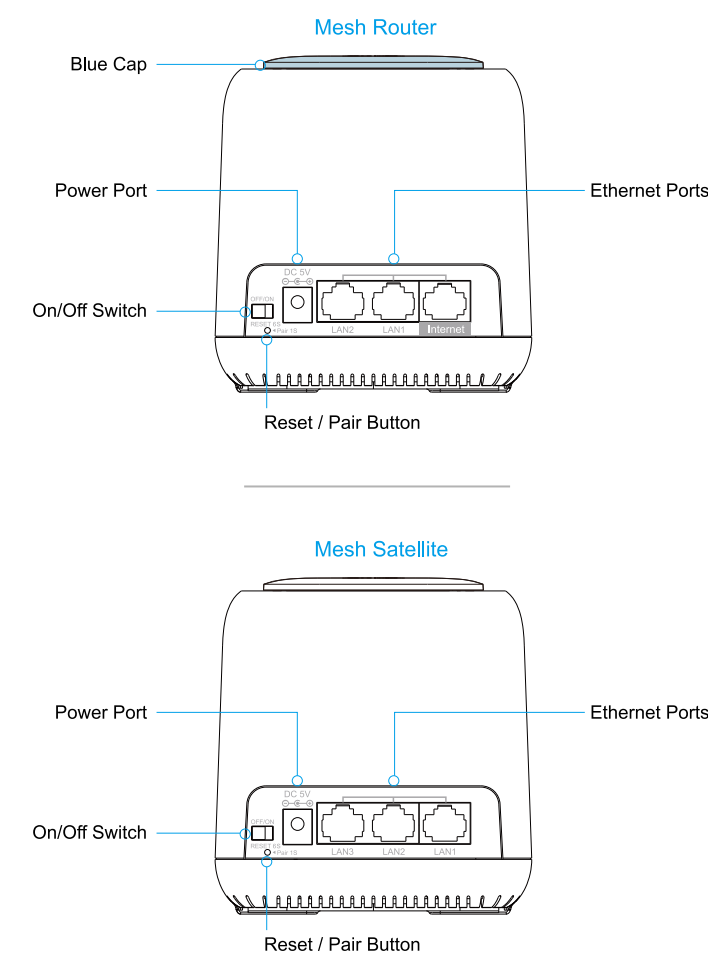

Hardware Connection

- Step 1:**
Unplug or power off your modem.
- Step 2:**
Cable your modem.

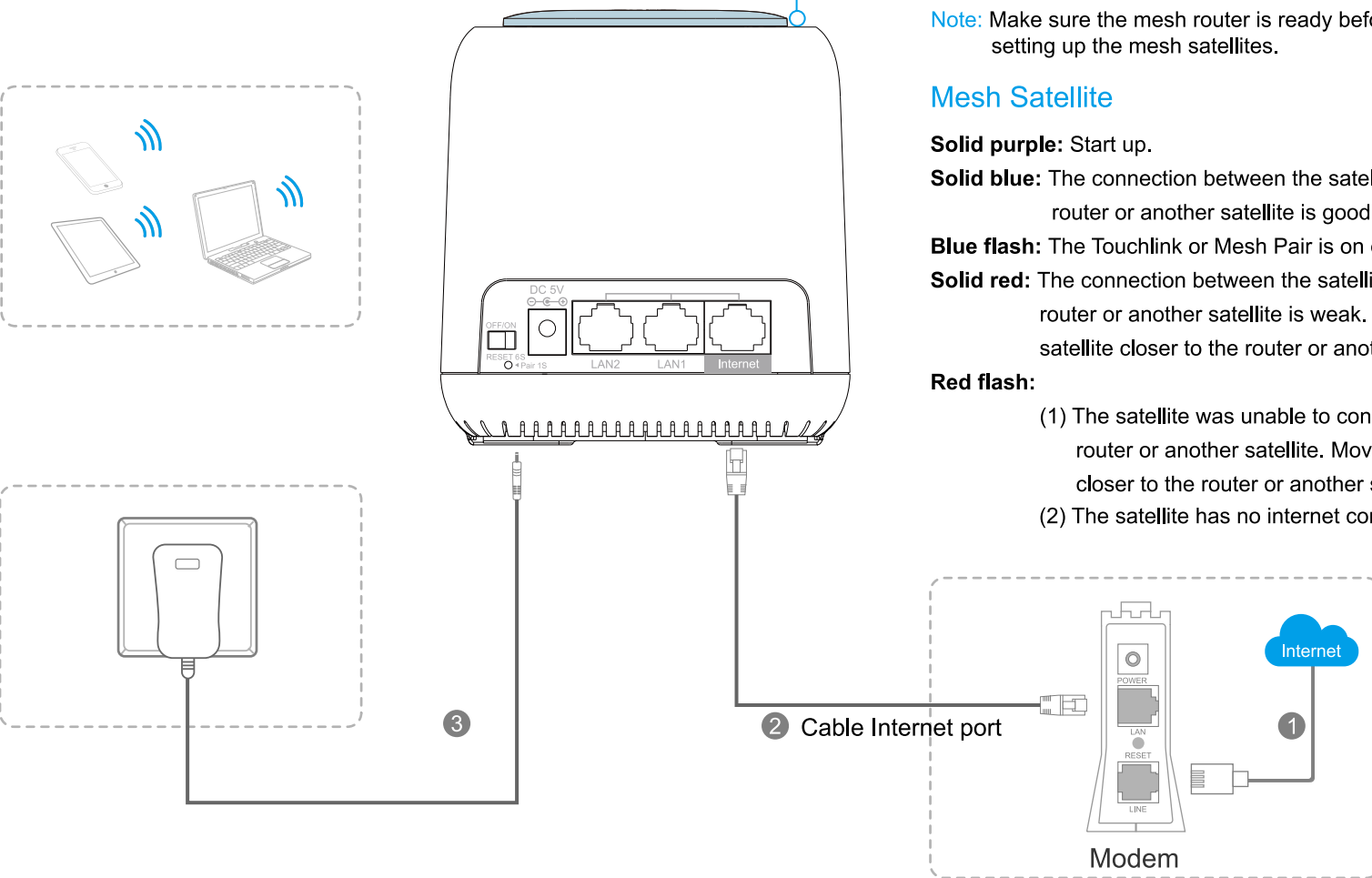

In the box
Mesh Router
Mesh Satellite(s)
RJ45 Ethernet Cable
Power Adapter(s)
Quick Guide

The square LED indicator

Mesh Router

- Solid purple:** Start up.
Solid blue: The Internet connection is ready.
Blue flash: The Touchlink or Mesh Pair is on open status.
Red flash: The router has no internet connection.
- Note:** Make sure the mesh router is ready before setting up the mesh satellites.

Mesh Satellite

- Solid purple:** Start up.
Solid blue: The connection between the satellite and the router or another satellite is good.
Blue flash: The Touchlink or Mesh Pair is on open status.
Solid red: The connection between the satellite and the router or another satellite is weak. Move the satellite closer to the router or another satellite.
Red flash:
(1) The satellite was unable to connect to the router or another satellite. Move the satellite closer to the router or another satellite.
(2) The satellite has no internet connection.

Default Parameters

- Default URL:** <http://ap.setup>
Default IP: 192.168.10.1
SSID: MeshGo
Touchlink SSID: MeshGo_Touch
Login Password: admin
- 2-in-1 Pair & Reset Button:**
Press and hold 6 seconds to reset the system.
Press and hold 1 second to pair an extra satellite.

TouchLink Technology

Touch and Connect | Make Sharing Easy

1. Touch the sensing area, the square LED (located on the top) flashes blue indicating that you can connect to the WIFI without the requirement of entering the password within 2 minutes.

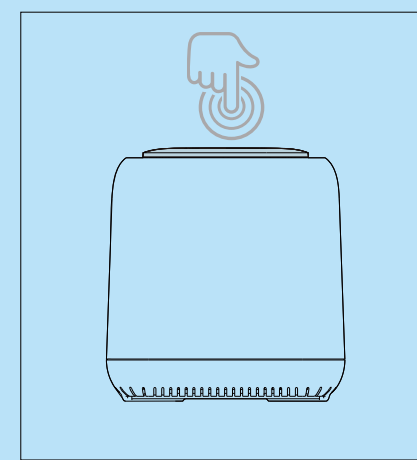

2. Select a network with '_Touch' in it, then confirm the connection.

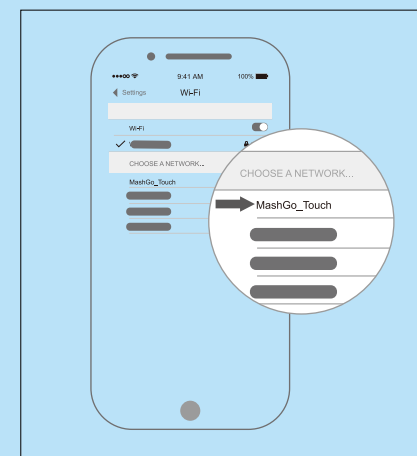

Note: Touchlink works for any smartphone, Pad, laptop etc.

正面

Set up your mesh Wi-Fi system using one of the following options

Via MeshGo App.

Follow these steps:

- Search for **MeshGo** (see the icon below) in the Apple App Store or Google Play Store.
- Download and launch the app on your mobile device and follow the prompts.



For Mac OS X User

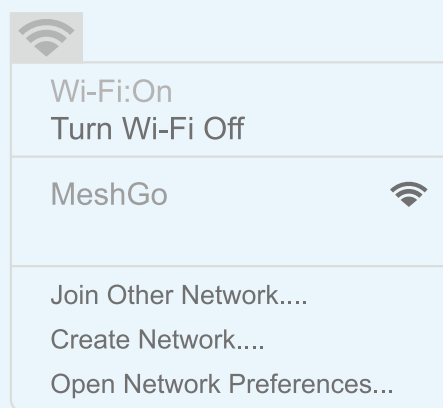

- Turn your laptop's Wi-Fi ON if it is OFF.
- Click the Wi-Fi icon on the top right corner of the screen, and connect to the router's network: **MeshGo**.

B3. Select Router.

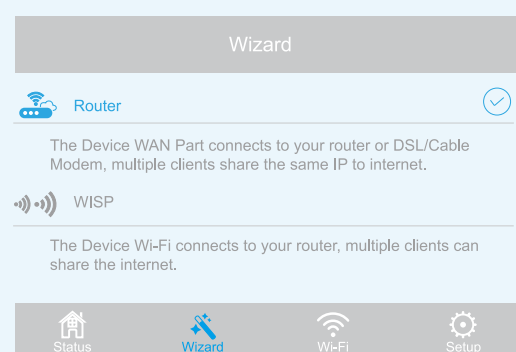

- When your Internet service starts, your Internet service provider (ISP) typically gives you all the information needed to connect to the internet. If you cannot locate this information, ask your ISP to provide it.

- From the **Internet Type** menu, select your Internet connection type from the drop-down list: **DHCP**, **PPPOE** or **STATIC**. And then, enter the information provided by your ISP in the corresponding fields.

Note: If you are not sure what your Internet type is, contact your Internet service provider (ISP) for assistance.

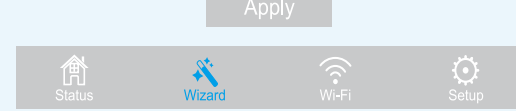
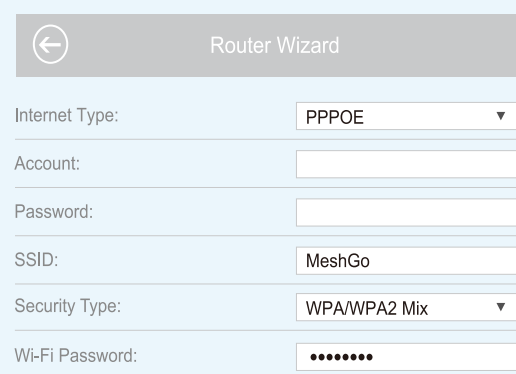

Tip: If you use DSL line and you are only provided an account name and a password by your ISP, choose **PPPoE**. If you use cable TV or fiber cable, choose **DHCP**. If you are provided information such as IP address, Subnet Mask and Default Gateway, choose **STATIC**.

- The default is **MeshGo**. You can use the default SSID or create your own SSID here.

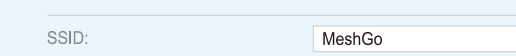

- From the **Security Type** menu, select a security type from the drop-down list (**WPA/WPA2 Mix** recommended). And create a Wi-Fi password for security purpose. Wi-Fi password is case-sensitive.

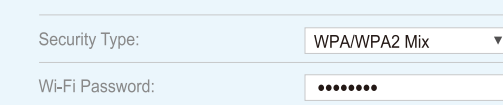

- Click **Apply**. Installation and basic setup takes a few minutes to complete.

3 Setup your satellites:

Mesh Wi-Fi Kit. If you purchased the Kit, we have paired the satellite(s) with the router. So you just need to find (an) ideal spot(s) to plug in the satellite(s).

Satellite. If you have already set up a mesh network system, and purchased extra satellites, use one of the following options to set up the extra satellites:

Option One. Via Web Browser:

- Launch a web browser, visit <http://ap.setup>, and log in.
- Go to **Wi-Fi -> Mesh Network**.
- From the **Extender MAC Address** menu, enter the MAC Address on the label of the satellite, then click **+** to join the mesh network.

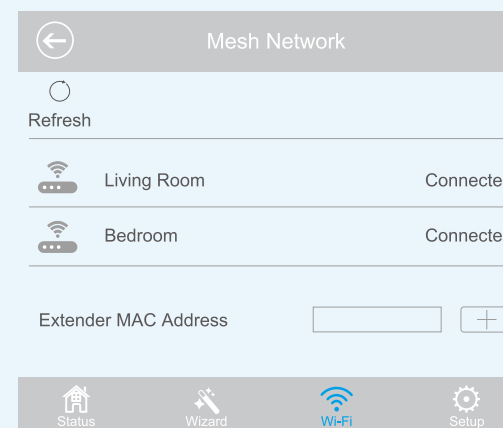

Option Two. Via Pair Button:

- Plug the satellite into a power outlet near the mesh router.
- Press and hold the reset button on the **mesh router** for 1 second, the square LED flashes blue. Within 2 minutes, press and hold the reset button on the **satellite** for 1 second. After the square LEDs of the router and the satellite light **solid blue**, the pair process is complete.
- Find an ideal spot, and reposition the satellite.

FAQ (Frequently Asked Questions)

- Q1. Why doesn't the login page appear after entering <http://ap.setup>?**
- Make sure your computer is set to obtain an IP address automatically.
 - Verify if <http://ap.setup> is correctly entered in the web browser. Alternatively, enter <http://192.168.10.1> in the web browser.
 - Use another web browser and try again.
 - Reboot your router and try again.
- Q2. What can I do if I cannot access the Internet?**
- Check if the Internet is working normally by connecting a computer directly to the modem using an Ethernet cable. If it is not, contact your Internet service provider.
 - Open a web browser, enter <http://ap.setup> or <http://192.168.10.1> and run the quick setup again.
 - Reboot your router and try again.
- Q3. How can I restore the router to its factory default settings?**
- While the router is powered on, press and hold the **Reset** button on the back for 6 seconds.
- Q4. What can I do if I forget my Administration Management password?**
- Refer to FAQ > Q3 to reset the router, and use the default **admin** (all lowercase) to log in.
- Q5. What can I do if I forget my wireless network password?**
- Log in the router's web management page at <http://ap.setup> and go to **Wi-Fi -> Wi-Fi Setup**, you can find your Wi-Fi password here.
- Q6. How to place the router or satellite to get the best Wi-Fi signal?**
- Keep the router or satellite in the most central spot in your home and away from anything that might block its signal such as metal objects, bodies of water, reinforced concrete walls, foil-insulated walls, and other similar construction materials may severely weaken a wireless signal passing through it.

GNU General Public License Notice

This product includes software codes developed by third parties. These software codes are subject to either the GNU General Public License (GPL), Version 2, June 1991 or the GNU Lesser General Public License (LGPL), Version 2.1, February 1999. You can copy, distribute, and/or modify in accordance with the terms and conditions of GPL or LGPL. The source code should be complete, if you want us to provide any additional source code files under GNU General Public License (GPL), please contact us in these matters. We are committed to meeting the requirements of the GNU General Public License (GPL). You are welcome to contact us local office to get the corresponding software and licenses. Please inform us your contact details (full address) and the product code. We will send you a software package with the software and license for free. The respective programs are distributed WITHOUT ANY WARRANTY; without even the implied warranty of MERCHANTABILITY or FITNESS FOR A PARTICULAR PURPOSE. Please refer to the GNU General Public License Web site for further information. <http://www.gnu.org/licenses/old-licenses/lgpl-2.0.html> <http://www.gnu.org/licenses/gpl.html>

WEEE Directive & Product Disposal
At the end of its serviceable life, this product should not be treated as household or general waste. It should be handed over to the applicable collection point for the recycling of electrical and electronic equipment, or returned to the supplier for disposal.

反面

名称：WN535 Mesh说明书中性-V1	
成品尺寸：84x99mm	展开：420x297mm
材质工艺：105g铜板+4C正反双面印刷+折叠	
修改时间：	
备注：	