

CK315

Smart Speaker With Alexa

User Manual





Start with CK315

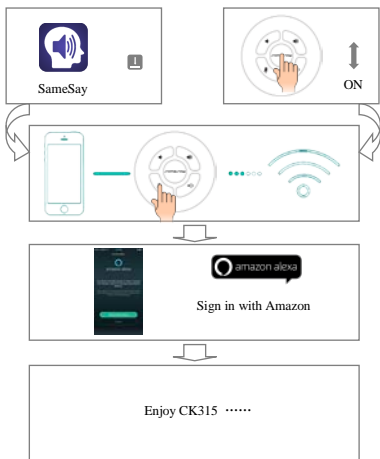

Control Panel & Back Panel

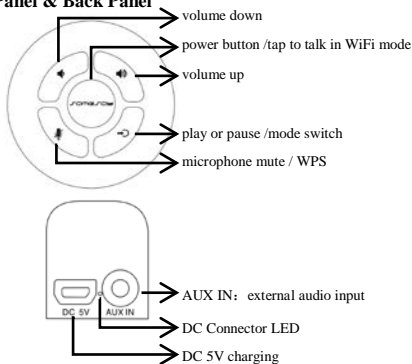

Download the SameSay APP

Download and install the SameSay APP to your phone. Then the APP will guide you to setup your device to the network, and you can also get more information from Amazon Alexa APP.



Both SameSay APP and Amazon Alexa APP can be downloaded from App Store or Google Play.

How to use CK315

1. Connecting your device to the internet by SameSay APP.
2. Login Amazon account.
3. Select your favorite sound source and play Now
4. Multi-room play: add devices to DEVICE LIST in your APP, then long press and drag slave device up to main device until they are in same room to play in sync. You can both control main device or slave devices.
5. Use Alexa Voice Service: ask a word "Alexa" to wake up and then give it an order, or tap to talk with the power button while in WiFi mode. If you want to get more Alexa skills you can go to the Alexa APP.

Play with Air Play

When CK315 WiFi speaker network connected, IOS users can use Air Play to achieve wireless music!





1. IOS 10 users: Slide up from the bottom of the device to open the Control Center and find the "Play in" screen in the horizontal direction, click , then select your CK315.
2. IOS 9 & IOS 8 users: Slide up from the bottom of the device to open the Control Center, Smoothies along the horizontal to find the "Play" screen, click , then select your CK315.

Use Android DLNA to play

When CK315 WiFi speaker network connected, Android users can use DLNA to play.

1. Open the phone or tablet comes with DLNA function of the music player software, click on the playback interface, click the push icon, and then select your CK315 device to play music.

Tips:

Push icon examples:			
Samsung 	HTC 	Sony 	Huawei 

·Make sure your WiFi is 2.4G Wi-Fi and the CK315 does not support the 5G.

·It is recommended that you use the router do not connect multiple internet devices, so as not to take up too much bandwidth and affect user's experience.

·Do not use in a complex Wi-Fi network environment (eg, office, hotel, multiple routers bridged, too many routers around, etc.) to avoid unrestricted connection, play cardon, connection failure, inability to use, etc.

Bluetooth mode

Long press mode switch button “” and select Bluetooth mode, or select Bluetooth mode on the SameSay APP. Then top LED will turn into blue and flashing. Pairing CK315's Bluetooth with your device (Such as: smart phones, tablet PCs, PC, Mac and so on). If CK315 Bluetooth connected, top LED stop flashing, also with a warning sound, then you can play content.

AUX IN mode

Long press mode switch button “” and select AUX mode, also you can select AUX mode on the SameSay APP. While equipments (such as: smart phones, tablet PCs, PC, Mac, etc.) are connected by cable to the AUX, you can play your content.

Specifications

1. Bluetooth version: V4.0
2. Bluetooth connection distance: connection distance \leq 10 m
3. Output Power: 5W
4. Bluetooth frequency range: 2.402GHz-2.480GHz
5. Wi-Fi generator frequency range: 2.412GHz-2.462GHz
6. Wi-Fi network compatible: IEEE 802.11b/g/n
7. Speaker impedance: 4 Ω

FCC WARNINGS

This equipment has been tested and found to comply with the limits for a Class B digital device, pursuant to part 15 of the FCC Rules. These limits are designed to provide reasonable protection against harmful interference in a residential installation. This equipment generates, uses and can radiate radio frequency energy and, if not installed and used in accordance with the instructions, may cause harmful interference to radio communications. However, there is no guarantee that interference will not occur in a particular installation. If this equipment does cause harmful interference to radio or television reception, which can be determined by turning the equipment off and on, the user is encouraged to try to correct the interference by one or more of the following measures:

- Reorient or relocate the receiving antenna.
- Increase the separation between the equipment and receiver.
- Connect the equipment into an outlet on a circuit different from that to which the receiver is connected.
- Consult the dealer or an experienced radio/TV technician for help.

Caution: Any changes or modifications to this device not explicitly approved by manufacturer could void your authority to operate this equipment.

This device complies with part 15 of the FCC Rules. Operation is subject to the following two conditions: (1) This device may not cause harmful interference, and (2) this device must accept any interference received, including interference that may cause undesired operation.

Radiation Exposure Statement

This equipment complies with FCC radiation exposure limits set forth for an uncontrolled environment. This equipment should be installed and operated with minimum distance 20cm between the radiator and your body.

This transmitter must not be co-located or operating in conjunction with any other antenna or transmitter.