

USB-AC56 Dual-band Wireless-AC1200 USB Adapter

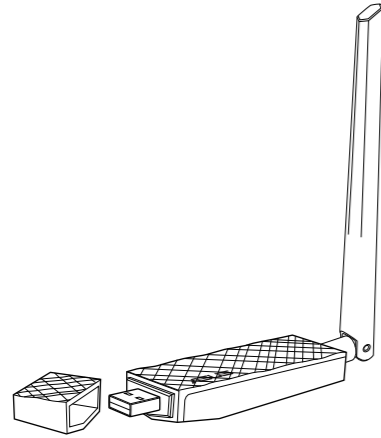

Quick Start Guide

ASUS Recycling/Takeback Services

ASUS recycling and takeback programs come from our commitment to the highest standards for protecting our environment. We believe in providing solutions for you to be able to responsibly recycle our products, batteries, other components, as well as the packaging materials. Please go to <http://csr.asus.com/english/Takeback.htm> for the detailed recycling information in different regions.

Installation

1. Insert the installation CD into the laptop's optical drive.
2. The InstallShield Wizard for ASUS WLAN Card Driver will launch. Click **Next**.
3. The adapter is shown being inserted into the laptop's USB port.

Utility Installation

1. In the ASUS Wireless LAN Card utility, click **Install ASUS WLAN Card Utilities/Driver**.
2. In the ASUS USB-AC56 WLAN Card Setup window, click **Next**.
3. In the ASUS USB-AC56 WLAN Card Setup window, choose the destination location and click **Next**.

Utility Installation

4. In the ASUS USB-AC56 WLAN Card Setup window, select the program folder and click **Next**.
5. In the ASUS USB-AC56 WLAN Card Setup window, click **Finish**.

Introduction

Package contents

- ASUS USB-AC56 Adapter x1
- Extension USB 3.0 Cradle x1
- Support CD x1
- Warranty card x1
- Quick Start Guide x1
- High gain detachable antenna x1

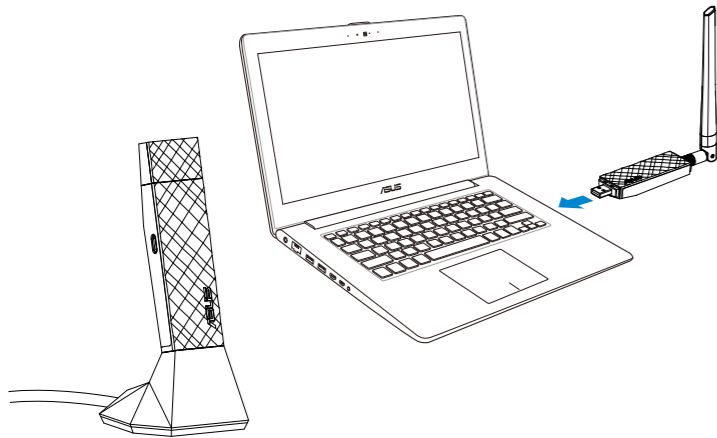

Connect to a wireless network

1. In the ASUS USB-AC56 Dual-Band USB Adapter utility, click **Survey**.
2. In the survey results table, select the network you want to connect to (ASUS_Router_5G) and click **Connect**.

Connect to a wireless network

3. In the Profile Configuration window, select **Infrastructure** and enter the network name (SSID) and security key. Click **Save**.
4. In the survey results table, the status of the selected network (ASUS_Router_5G) is now **Connected**.

Check the Status

Host Information	Ethernet Information
Host name: Sean1-Chou-PCI	Physical address: 00:ED:4C:88:12:01
Node type: Hybrid Node	IP address: 192.168.10.125
DNS server: 192.168.10.1	Submask: 255.255.255.0
	Default gateway: 192.168.10.1
	DHCP server: 192.168.10.1
	Preferred WINS server:
	Other WINS server:

